



Technical datasheet

TAB200



Brand	EREA
Article Number	TAB200
EAN-code Barcode	5414503004864
Code	2723
Product type	Single-phase autotransformer
Primary Voltage	0-110-130-230-240V AC
Secondary Voltage	0-110-130-230-240V AC
Power	200 VA
Standards	EN 61558-2-13

General properties

Applications	For all applications	Maximum ambient temperature ta	40 °C
Protection class	Prepared for protection class II	Temperature class transfo	E
Degree of protection	IP00	Finishing	Vacuum-encapsulated with synthetic resin

Electrical properties

Frequency	50-60 Hz	Efficiency	92 %
Po	5,4 W	Pcu	12 W
Specific property	Reversible		

Mechanical properties

Primary connection	Screw terminals 4 mm ²
Secondary connection	Screw terminals 4 mm ²
Fixation	Fixing lugs (original supply)

Dimensions/weight

Dimensions AxBxC	83x70x98 mm
Dimension D	62 mm
Dimension E	50 mm
Dimension Φ	5 mm
Weight	1,7 kg

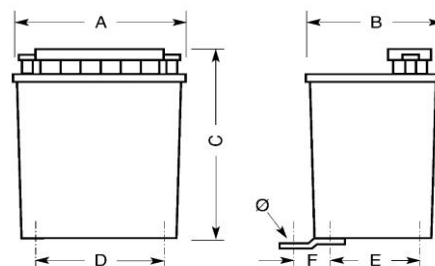

rev. 03.12.2020