



Technical datasheet

EDR 230TI160



Brand	EREA
Article Number	EDR 230TI160
EAN-code Barcode	5414503003324
Code	2303
Product type	Single-phase isolating transformer
Primary Voltage	230-400V AC
Secondary Voltage	0-0-230V AC
Power	160 VA
Standards	EN 61558-2-4 EN 60742

General properties

Applications	For all applications	Maximum ambient temperature ta	50 °C
Protection class	Prepared for protection class II	Temperature class transfo	B
Degree of protection	IP20	Finishing	Vacuum-encapsulated with synthetic resin

Electrical properties

Frequency	50-60 Hz	Efficiency	89 %
Po	6,2 W	Pcu	14 W
Dielectric Strength	4500 Vac	Insulation resistance	200 MΩ
Dielectric strength referred to frame	-	Specific property	-
Voltage drop (dU%)	8,4 %	Short-circuit voltage (Ucc %)	9,6 %

Mechanical properties

Primary connection	Screw terminals 4 mm ²
Secondary connection	Screw terminals 4 mm ²
Fixation	DIN-rail mounting

Dimensions/weight

Dimensions AxBxC	101x79x112 mm
Dimension D	84 mm
Dimension E	62 mm
Dimension Φ	6 mm
Weight	3 kg

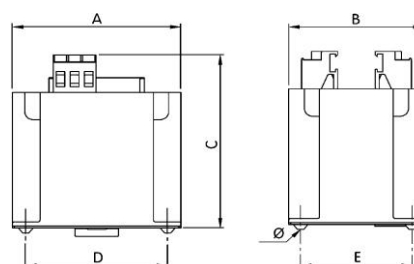

rev. 02.12.2020

