



Technical datasheet

E 24TC400



Brand	EREA
Article Number	E 24TC400
EAN-code Barcode	5414503003102
Code	2225
Product type	Single-phase control transformer
Primary Voltage	15-0-230-400V AC
Secondary Voltage	0-24V AC
Power	400 VA
Standards	EN 61558-2-2 EN 61558-2-6 EN 60742

General properties

Applications	For all applications, especially designed for inrush power in	Maximum ambient temperature ta	50 °C
Protection class	Prepared for protection class II	Temperature class transfo	B
Degree of protection	IP20	Finishing	Vacuum-encapsulated with synthetic resin

Electrical properties

Frequency	50-60 Hz	Efficiency	92 %
Po	15,5 W	Pcu	17,6 W
Dielectric Strength	4500 Vac	Insulation resistance	200 MΩ
Dielectric strength referred to frame	-	Specific property	-
Voltage drop (dU%)	4,3 %	Short-circuit voltage (Ucc %)	3,8 %

Mechanical properties

Primary connection	Screw terminals 4 mm ²
Secondary connection	Screw terminals 6 mm ²
Fixation	Angle sections with fixing holes

Dimensions/weight

Dimensions AxBxC	130x110x132 mm
Dimension D	105 mm
Dimension E	90 mm
Dimension Φ	6 mm
Weight	6 kg

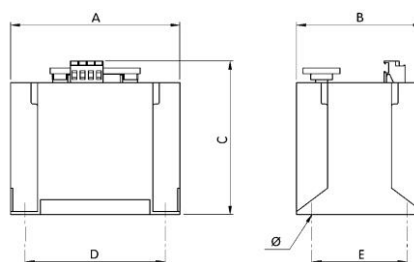

rev. 18.11.2020

