



Technical datasheet

E 212SC630 SK



Brand	EREA
Article Number	E 212SC630 SK
EAN-code Barcode	5414503002273
Code	1525
Product type	Single-phase safety transformer
Primary Voltage	230-240V AC
Secondary Voltage	2x 0-11,6V AC
Power	630 VA
Standards	EN 61558-2-6 EN 60742

General properties

Applications	Halogen lighting (12V or 24V)	Maximum ambient temperature ta	40 °C
Protection class	II	Temperature class transfo	B
Degree of protection	IP20	Finishing	Vacuum-encapsulated with synthetic resin

Electrical properties

Frequency	50-60 Hz	Efficiency	93,3 %
Po	25 W	Pcu	18 W
Protection	Manually resettable		

Mechanical properties

Primary connection	Screw terminals 6 mm ²
Secondary connection	Screw terminals 6 mm ²
Fixation	Angle sections with fixing holes

Dimensions/weight

Dimensions AxBxC	165x120x190 mm
Dimension D	130 mm
Dimension E	95 mm
Dimension Φ	6 mm
Weight	9 kg

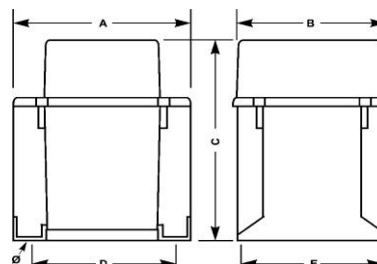

rev. 02.12.2020