



Technical datasheet

E 2115TI250



Brand	EREA
Article Number	E 2115TI250
EAN-code Barcode	5414503039835
Code	3983
Product type	Single-phase isolating transformer
Primary Voltage	230-400V AC
Secondary Voltage	2 x 0-115V AC
Power	250 VA
Standards	EN 61558-2-4 EN 60742

General properties

Applications	For all applications	Maximum ambient temperature ta	50 °C
Protection class	Prepared for protection class II	Temperature class transfo	B
Degree of protection	IP20	Finishing	Vacuum-encapsulated with synthetic resin

Electrical properties

Frequency	50-60 Hz	Efficiency	91 %
Po	10,3 W	Pcu	16 W
Dielectric Strength	4500 Vac	Insulation resistance	200 MΩ
Dielectric strength referred to frame	-	Specific property	-
Voltage drop (dU%)	5,9 %	Short-circuit voltage (Ucc %)	7,2 %

Mechanical properties

Primary connection	Screw terminals 4 mm ²
Secondary connection	Screw terminals 4 mm ²
Fixation	Angle sections with fixing holes

Dimensions/weight

Dimensions AxBxC	102x102x110 mm
Dimension D	84 mm
Dimension E	86 mm
Dimension Φ	6 mm
Weight	4 kg

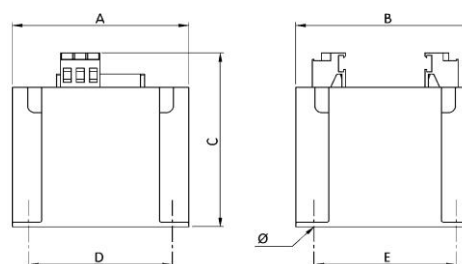

rev. 02.12.2020

