



Technical datasheet

E 12SC300 SKA



Brand	EREA
Article Number	E 12SC300 SKA
EAN-code Barcode	5414503001566
Code	1535
Product type	Single-phase safety transformer
Primary Voltage	230-240V AC
Secondary Voltage	11,6V AC
Power	300 VA
Standards	EN 61558-2-6 EN 60742

General properties

Applications	Halogen lighting (12V)	Maximum ambient temperature ta	40 °C
Protection class	II	Temperature class transfo	B
Degree of protection	IP20	Finishing	Vacuum-encapsulated with synthetic resin

Electrical properties

Frequency	50-60 Hz	Efficiency	90,5 %
Po	20,3 W	Pcu	9,7 W
Protection	Manually resettable		

Mechanical properties

Primary connection	Screw terminals 6 mm ²
Secondary connection	Screw terminals 6 mm ²
Fixation	Fixing lugs (original supply)

Dimensions/weight

Dimensions AxBxC	135x115x160 mm
Dimension D	105 mm
Dimension E	90 mm
Dimension Φ	6 mm
Weight	6 kg

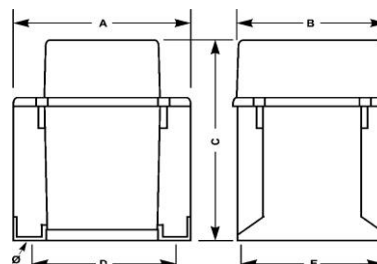

rev. 02.12.2020