



# Technical datasheet

## BAT1500



Brand	EREA
Article Number	BAT1500
EAN-code Barcode	5414503000446
Code	2524
Product type	Portable single-phase transformer
Primary Voltage	110-130-230V AC
Secondary Voltage	110-130-230V AC
Power	1 500 VA
Standards	EN 61558-2-13

### General properties

Applications	For all applications	Maximum ambient temperature ta	40 °C
Protection class	I	Temperature class transfo	E
Degree of protection	IP20	Finishing	-

### Electrical properties

Frequency	50-60 Hz	Efficiency	97 %
Po	22,4 W	Pcu	23,5 W
Specific property	Reversible Portable		

### Mechanical properties

Primary connection	Power cord
Secondary connection	Socket
Fixation	-

### Dimensions/weight

Dimensions AxBxC	240x150x200 mm
Dimension D	-
Dimension E	-
Dimension Φ	-
Weight	14,0 kg

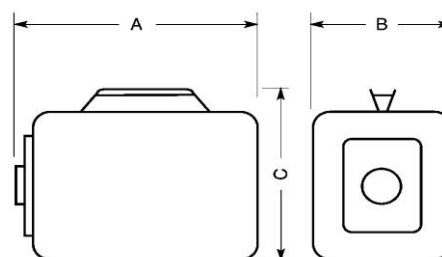

rev. 03.12.2020