



Technical datasheet

BAT1000



| | |
|-------------------|-----------------------------------|
| Brand | EREA |
| Article Number | BAT1000 |
| EAN-code Barcode | 5414503000439 |
| Code | 2523 |
| Product type | Portable single-phase transformer |
| Primary Voltage | 110-130-230V AC |
| Secondary Voltage | 110-130-230V AC |
| Power | 1 000 VA |
| Standards | EN 61558-2-13 |

General properties

| | | | |
|----------------------|----------------------|--------------------------------|-------|
| Applications | For all applications | Maximum ambient temperature ta | 40 °C |
| Protection class | I | Temperature class transfo | E |
| Degree of protection | IP20 | Finishing | - |

Electrical properties

| | | | |
|-------------------|------------------------|------------|--------|
| Frequency | 50-60 Hz | Efficiency | 96,4 % |
| Po | 16,1 W | Pcu | 21,5 W |
| Specific property | Reversible Portable | | |

Mechanical properties

| | |
|----------------------|------------|
| Primary connection | Power cord |
| Secondary connection | Socket |
| Fixation | - |

Dimensions/weight

| | |
|------------------|----------------|
| Dimensions AxBxC | 240x150x200 mm |
| Dimension D | - |
| Dimension E | - |
| Dimension Φ | - |
| Weight | 10,2 kg |

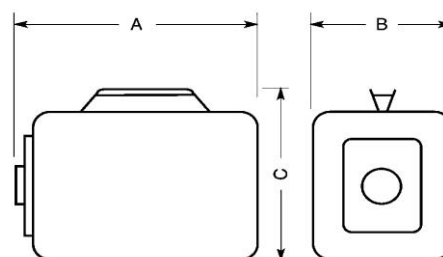

rev. 03.12.2020